



2390 NW FEDERAL HIGHWAY

Stuart, Florida 34994



PROPERTY FOR LEASE

- Class A retail space available from 1,850 to 3,700 square feet
- Excellent visibility and access on the major retail corridor of Federal Highway
- Located just 1/2 mile South of the Treasure Coast Mall
- Property is occupied by strong national retail tenants

DEMOGRAPHIC SUMMARY

	3-MILE RADIUS	5-MILE RADIUS
Postal count population	35,830	102,759
Median age	52.7	53.3
Estimated average household income	\$83,076	\$77,366
Estimated median household income	\$53,934	\$51,593

Cohen Commercial Realty, Inc.

Bryan S. Cohen | info@cohencommercial.com

Office: 561.471.0212 • Leasing: 561.471.1299 • Fax: 561.471.5905

533 NORTHLAKE BOULEVARD • NORTH PALM BEACH, FL 33408 POST OFFICE BOX 14127 • NORTH PALM BEACH, FL 33408

LICENSED REAL ESTATE BROKER

All information regarding this property has been obtained from sources believed to be reliable. We make no guarantee, warranty, or representation about it. It independently confirm its accuracy and completeness. Any projections, assumptions, opinions or estimates used are for example only and do not represent current or future performance. You and your advisors should conduct a careful, independent investigation of the property to determine to your satisfaction the suitability of the property for your needs.



SITE PLAN

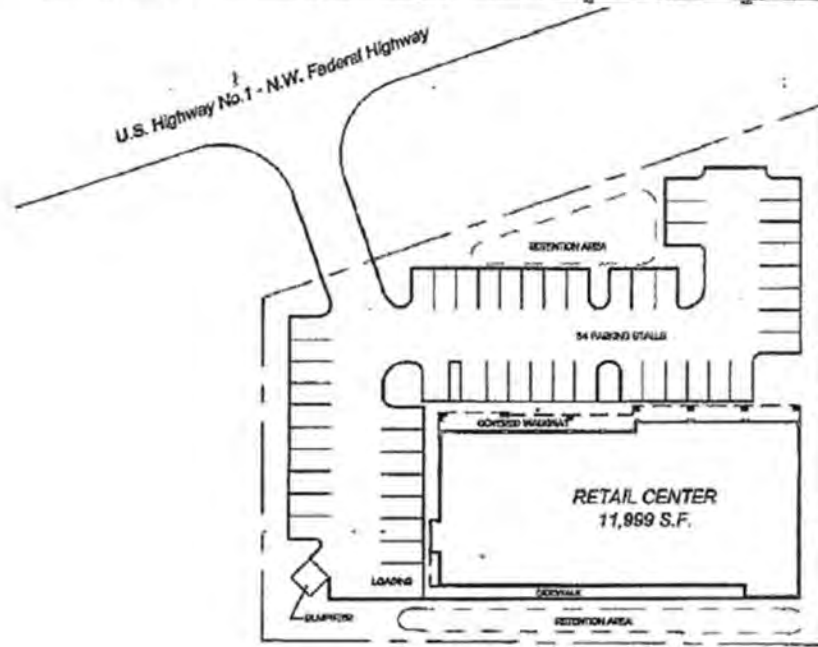
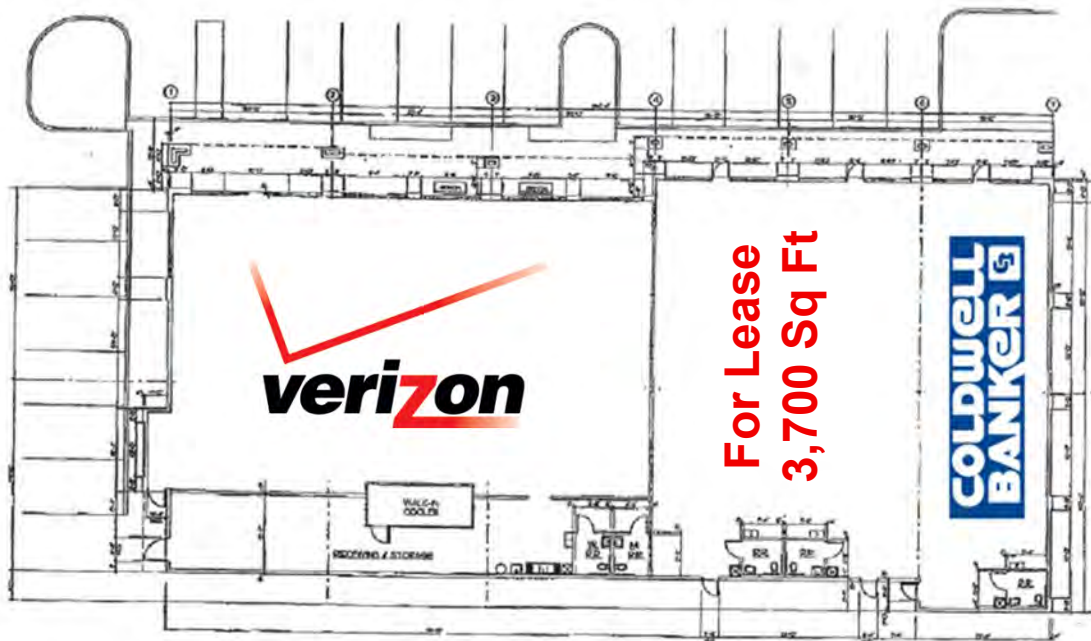

Cohen Commercial Realty, Inc.

Bryan S. Cohen | info@cohencommercial.com

Office: 561.471.0212 • Leasing: 561.471.1299 • Fax: 561.471.5905

533 NORTHLAKE BOULEVARD • NORTH PALM BEACH, FL 33408 POST OFFICE BOX 14127 • NORTH PALM BEACH, FL 33408

LICENSED REAL ESTATE BROKER

All information regarding this property has been obtained from sources believed to be reliable. We make no guarantee, warranty, or representation about it. It independently confirm its accuracy and completeness. Any projections, assumptions, opinions or estimates used are for example only and do not represent current or future performance. You and your advisors should conduct a careful, independent investigation of the property to determine to your satisfaction the suitability of the property for your needs.